

# Pendant Systems

The Lighting Suspension Specialists [www.PendantSystems.com](http://www.PendantSystems.com) P-215-638-8552 F-215-638-8554

## Introducing Mono Point Magnet Mounted Kits

Magnet Mounted Kits allow you to lose the Slip Ring on the outside of the canopy. The Magnets support the canopy to the ceiling offering a beautiful & sleek look.

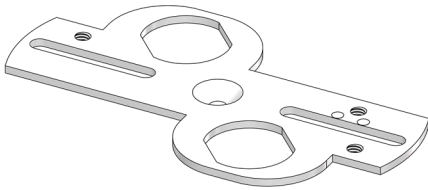

**Mag Bar**  
Cross Bar for Magnet Use  
Accommodates #126 & #171  
4.140" L x 1.000" W



**T-Bar Coupler**  
Coupler for Half Ball Cable  
Used with Magnet to support  
canopy with T-Bar application

### Feed Kit

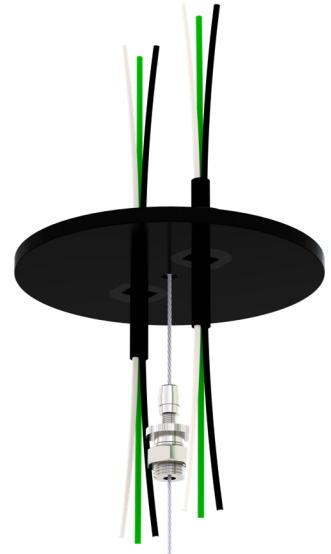
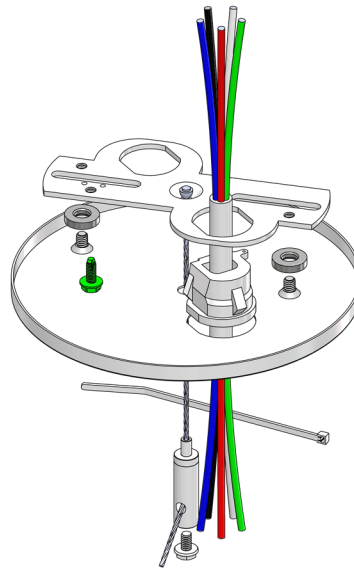

### Non-Feed Kit

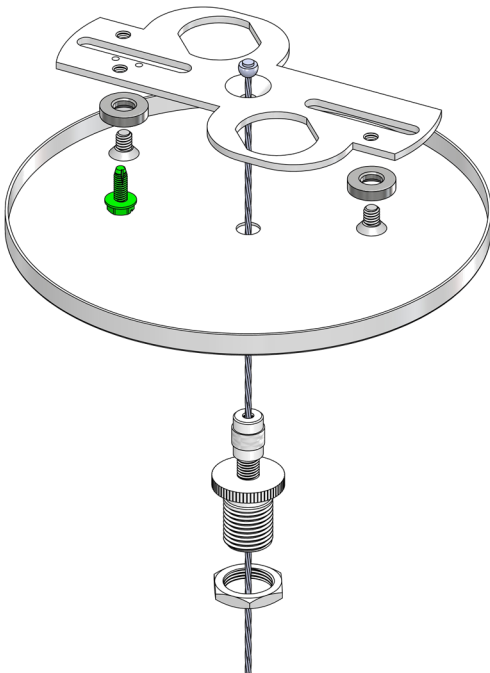

### T-Bar Non-Feed Kit



# Pendant Systems

The Lighting Suspension Specialists www.PendantSystems.com P-215-638-8552 F-215-638-8554

## MONO POINT STEM SERIES: MAGNET SWIVEL STEM FEED SYSTEM

- Sleek Design
- Available in Round or Square Canopies
- Single Point Mounting System for feed and fixture support from a center location
- Minimizes fixture movement
- Stem lengths are fixed and available in 1/8"IPS, 1/4"IPS, 3/8"IPS & 1/2"IPS diameters. Patent# US 9133981B2
- (Stems must be ordered separately).
- Swivel Rotation depends on the size of stem. 1/8"IPS (45°), 1/4"IPS (45°), 3/8"IPS (42°) & 1/2"IPS (38°)
- Available in Field Cut Adjustable System to cut and pin stem to desired height without threading stem for 3/8"IPS, 1/4"IPS & 1/8"IPS sizes (Add Suffix ADJ); Drill Bit & Allen wrench are included (Tool Kit)

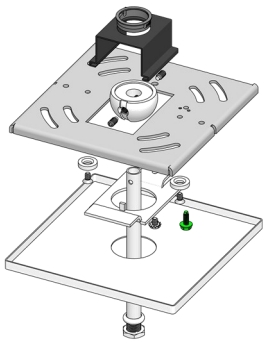

MP-SW1/8 MAG ADJ- 1/8"IP MP SWIVEL STEM KIT

- 1- MP Crossbar: Mono Point Base Crossbar
- 1-#32: 8/32" x 5/16" Ground Screw
- 1-#276B SQ: 5" Square Canopy w/1.180" CH
- 1-#133: 1/8"IP Hex Nut 1/8" Thick
- 1-#183: 8/32" x1/4" Phillips Zinc Screw
- 1-MP PLATE HB: Mono Point Crossbar Center Plate
- 1-272 ADJ: 1/8"IPS Adjustable Half Ball
- 1-MP SWIVEL CLIP: Mono Point Retaining Clip
- 1-#237: 7/8" Hole Bushing
- 2-Magnet: #6 & #8 Holes
- 2-#271: 6/32" x 1/4" L Flat Head Screw
- 2-#273: 8/32" x .3235" L Half Dog Point Set Screw

See website for more  
Monopoint Swivel Magnet kits in  
1/4" IP, 3/8"IP & 1/2"IP.

**Sample  
Square Magnet kit with  
Field Adjustable Half Ball**

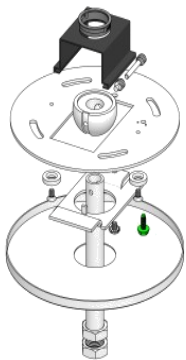

MP-SW1/4 RD MAG ADJ- 1/4"IP MP SWIVEL STEM KIT

- 1- MP Crossbar Round: Mono Point Base Crossbar
- 1-#32: 8/32" x 5/16" Ground Screw
- 1-#276B: 5" Round Canopy w/1.180" CH
- 2-#64: 1/4"IP Hex Nut 1/4" Thick
- 1-#183: 8/32" x1/4" Phillips Zinc Screw
- 1-MP PLATE HB: Mono Point Crossbar Center Plate
- 1-35 ADJ WPB: 1/4"IPS Adjustable Half Ball White
- 1-ADJ-SS: 1/4"-20 Short Allen Hex Head Pin
- 1-SSS: 1/4"-20 Long Allen Hex Head Pin
- 1-MP SWIVEL CLIP: Mono Point Retaining Clip
- 1-#237: 7/8" Hole Bushing
- 2-Magnet: #6 & #8 Holes
- 2-#271: 6/32" x 1/4" L Flat Head Screw

**Sample  
Round Magnet kit with  
Field Adjustable Half Ball**

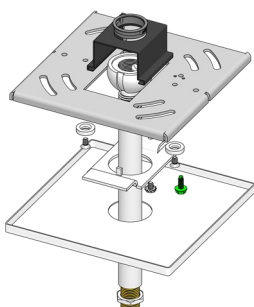

MP-SW3/8 MAG ID -3/8"IP MP SWIVEL STEM KIT

- 1- MP Crossbar: Mono Point Base Crossbar
- 1-#32: 8/32" x 5/16" Ground Screw
- 1-#276B SQ: 5" Square Canopy w/1.180" CH
- 1-#183: 8/32" x1/4" Phillips Zinc Screw
- 1-MP PLATE HB: Mono Point Crossbar Center Plate
- 1-34: 3/8"IPS Half Ball White
- 1-MP SWIVEL CLIP: Mono Point Retaining Clip
- 1-237: 7/8" Hole Bushing
- 2-Magnet: #6 & #8 Holes
- 2-#271: 6/32" x 1/4" L Flat Head Screw
- 1-#25: 1/4"IP Nut 1/8" Thick
- 1-#49-1: 1/4" IP Nipple 1" L

**Sample  
Square Magnet kit with ID  
thread stem**

Patent# US 9133981B2

# Pendant Systems

The Lighting Suspension Specialists www.PendantSystems.com P-215-638-8552 F-215-638-8554

## MONO POINT STEM SERIES: MAGNET EXIT SIGN SYSTEM

- **Single Point Mounting System** for feed and fixture support from a center location for Exit Signs
- **Available in Round and Square Canopies**
- **Stem lengths are fixed and available in 1/4"IPS and 3/8"IPS.** (Stems must be ordered separately).
- **The Exit Bracket is adaptable to most signs** because it has multiple tapped holes for different mounting patterns

Patent# US 9133981B2

### MP-ST1/4 Exit RD MAG- 1/4" IP Mono Point Exit Stem Kit

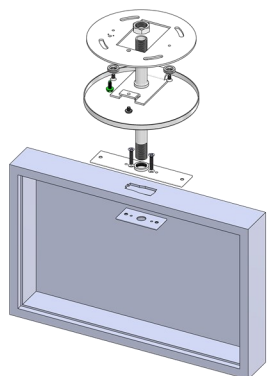

- 1- MP Crossbar Round: Mono Point Base Crossbar
- 1-#32: 8/32" x 5/16" Slot Ground Screw
- 1-#278B: 5" Square Canopy w/.530" CH
- 1-#64: 1/4"IP Hex Nut 1/4" Thick
- 1-#183: 8/32" x 1/4" Phillips Zinc Screw
- 1-MP PLATE 1/4IP: MP Plate w/ 1/4"IP Tapped CH
- 1-Exit Base: Bracket 6/32" Tapped & Slip Holes
- 1-Exit BRKT 1/4 IP: 1/4" IP Tapped CH & 6/32" Tapped
- 2-Exit BRKT Screw: 6/32" x 3/4" L Flat Head Phillips
- 2-Magnet: #6 & #8 Holes
- 2-#271: 6/32" x 1/4" L Flat Head Screw

**Sample Round Exit  
Magnet kit**

### MP-ST3/8 Exit MAG - 3/8"IP Mono Point Exit Stem Kit

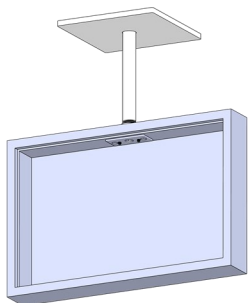

- 1- MP Crossbar: Mono Point Base Crossbar
- 1-#32: 8/32" x 5/16" Ground Screw
- 1-#277B SQ: 5" Square Canopy w/.660" CH
- 1-#22: 3/8"IP Square Nut
- 1-#183: 8/32" x 1/4" Phillips Zinc Screw
- 1-MP PLATE 3/8IP: MP Plate w/ 3/8"IP Tapped CH
- 1-Exit Base: Bracket 6/32" Tapped & Slip Holes
- 1-Exit BRKT 3/8 IP: 3/8" IP Tapped CH & 6/32" Tapped
- 2-Exit BRKT Screw: 6/32" x 3/4" L Flat Head Phillips
- 2-Magnet: #6 & #8 Holes
- 2-#271: 6/32" x 1/4" L Flat Head Screw

**Sample Square Exit  
Magnet kit**

# Pendant Systems

The Lighting Suspension Specialists www.PendantSystems.com P-215-638-8552 F-215-638-8554

## MONO POINT STEM SERIES: MAGNET FIXED STEM FEED SYSTEM

- Single Point Mounting System for feed and fixture support from a center location
  - Minimizes fixture movement
  - Low profile with recessed 6/32" painted mounting screws for canopy
  - Stem lengths are fixed and available in 1/4"IPS, 3/8"IPS & 1/2"IPS diameters.
- (Stems must be ordered separately)

Patent# US 9133981B2

### MP-ST1/4 MAG ID-1/4" IP MONO POINT STEM KIT

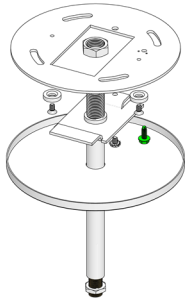

- 1- MP Crossbar: Mono Point Base Crossbar
- 1-#32: 8/32" x 5/16" Slot Ground Screw
- 1-#278B SQ: 5" Square Canopy w/.530" CH
- 1-#64: 1/4"IP Hex Nut 1/4" Thick
- 1-#183: 8/32" x1/4" Phillips Zinc Screw
- 1-MP PLATE 1/4IP:MP Plate w/ 1/4"IP Tapped CH
- 1-#60-1: 1/8" IP Nipple 1" L
- 1-#133: 1/8" IP Nut 1/8" Thick
- 2-Magnet: #6 & #8 Holes
- 2-#271: 6/32" x 1/4" L Flat Head Screw

**Sample of a Round Magnet Fixed Stem Kit for a Internal threaded stem**

### MP-ST3/8 MAG- 3/8"IP MONO POINT STEM KIT

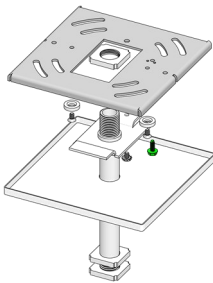

- 1- MP Crossbar: Mono Point Base Crossbar
- 1-#32: 8/32" x 5/16" Ground Screw
- 1-#277B SQ: 5" Square Canopy w/.660" CH
- 3-#22: 3/8"IP Square Nut
- 1-#183: 8/32" x1/4" Phillips Zinc Screw
- 1-MP PLATE 3/8IP: MP Plate w/ 3/8"IP Tapped CH
- 2-Magnet: #6 & #8 Hole
- 2-#271: 6/32" x 1/4" Flat Head Screw

**Sample of a Square Magnet Fixed Stem Kit**

### MP-ST1/2 RD MAG-1/2"IP MONO POINT STEM KIT

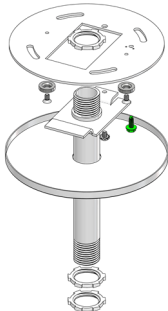

- 1- MP Crossbar Round: Mono Point Base Crossbar
- 1-#32: 8/32" x 5/16" Ground Screw
- 1-#279B: 5" Round Canopy w/.845" CH
- 3-#77: 1/2"IP Lock Nut
- 1-#183: 8/32" x1/4" Phillips Zinc Screw
- 1-MP PLATE 1/2IP: MP Plate w/ 1/2"IP Tapped CH
- 2-Magnet: #6 & #8 Holes
- 2-#271: 6/32" x 1/4" L Flat Head Screw

**Sample of a Round Magnet Fixed Stem Kit**

### Stems

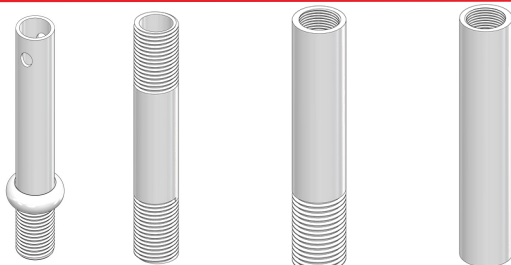

1/4" IPS, 3/8" IPS, and 1/2" IPS Stems are 16 gauge steel tubing and threaded 3/4" at each end.

Internal Diameter threading is now available on 1/4" IPS (1/8" IP thread) & 3/8" IPS (1/4" IP thread) steel tubing.

1/8"IPS Stem With Bead Nut and Pin Holes  
20 Gauge x 36"Length x 9/16" Thread

# Pendant Systems

The Lighting Suspension Specialists [www.PendantSystems.com](http://www.PendantSystems.com) P-215-638-8552 F-215-638-8554

## Magnet Mount Stem Kits

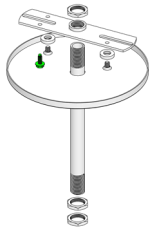

- C-415 MAG Canopy Kit for 1/4" IP Stem  
 1-#278B Flat Canopy  
 1-#39 1/4" IP Tapped Crossbar W/GS  
 3-#25 1/4" IP Hex Nuts  
 2-Magnets #6 & #8 Holes  
 2-#270 8/32" Screws

Canopy set is also available in Square

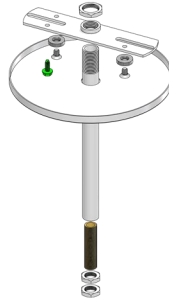

- C-415 MAG ID Canopy Kit for 1/4" IP Stem  
 1-#278B Flat Canopy  
 1-#39 1/4" IP Tapped Crossbar W/GS  
 1-#25 1/4" IP Hex Nuts  
 2-Magnets  
 2-#270 8/32" Screws  
 1-#60-1.5: 1/8" IP Nipple 1.5" L  
 1-#133: 1/8" IP Nut 1/8" Thick

Canopy set is also available in Square

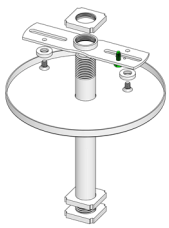

- C-515 MAG Canopy Kit for 3/8" IP Stem  
 1-#277B Flat Canopy  
 1-#38 Crossbar Zinc W/GS  
 3-#22 3/8" IP Lock Nuts  
 2-Magnets  
 2-#270 8/32" Screw

Canopy set is also available in Square

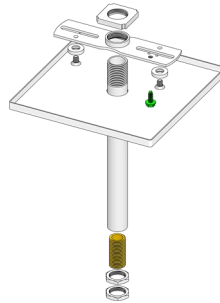

- C-515 MAG SQ ID Canopy Kit for 3/8" IP Stem  
 1-#277B SQ Flat Canopy  
 1-#38 Crossbar Zinc W/GS  
 1-#22 3/8" IP Lock Nuts  
 2-#25 1/4" IP Lock Nuts  
 1-#49-1 1/4" IP Nipple 1" L  
 2-Magnets  
 2-#270 8/32" Screws

Canopy set is also available in Round

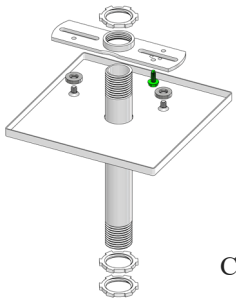

- C-615 Square MAG Canopy Kit for 1/2" IP Stem  
 1-#146 Flat Canopy S.R.I. White  
 1-#159 1/2" IP Tapped Crossbar W/GS  
 2-#77 1/2" IP Lock Nuts  
 2-Magnets  
 2-#270 8/32" Screw

Canopy set is also available in Round

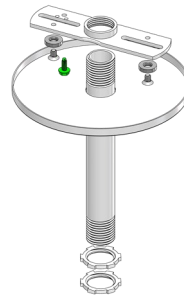

- C-615 MAG Canopy Kit for 1/2" IP Stem  
 1-#88 Flat Canopy S.R.I. White  
 1-#159 1/2" IP Tapped Crossbar W/GS  
 2-#77 1/2" IP Lock Nuts  
 2-Magnets  
 2-#270 8/32" Screw

## Exit Magnet Mount Stem Kits

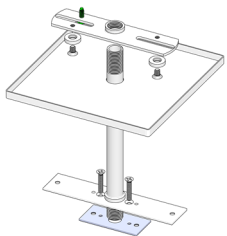

- C-415 Square Exit MAG Canopy Kit for 1/4" IP Stem  
 1-#278B Flat Canopy  
 1-#39 Crossbar Zinc W/GS  
 2-#64 1/4" IP Lock Nuts  
 2-Magnets  
 2-#270 8/32" Screw  
 1-Exit Base  
 1-Exit Bracket 1/4" IP White  
 2-Mono Point Screws

Canopy set is also available in Round

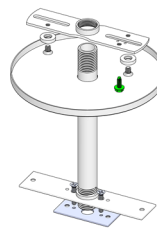

- C-515 Exit MAG Canopy Kit for 3/8" IP Stem  
 1-#277B 5" Flat Canopy w/ .660" CH  
 1-#38 Crossbar Zinc W/GS  
 2-#22 3/8" IP Lock Nuts  
 2-Magnet  
 2-#270 8/32" x 1/4" screw  
 1-Exit Base  
 1-Exit Bracket 3/8" IP White  
 2-Mono Point Screws

Canopy set is also available in Square

## Magnet Track Clip Kits

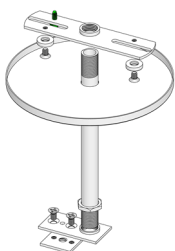

- C-415 TC MAG Canopy Kit for 1/4" IP Stem for Track system  
 1-#278B 5" Flat Canopy w/ .530" CH  
 1-#39 1/4" IP Tapped Crossbar W/GS  
 1-#25 1/4" IP Hex Nuts  
 2-Magnet  
 2-#270 8/32" x 1/4" L Screw  
 1-Track Base  
 1- TC1/4: 1/4" IP Threaded Top Plate  
 2-#217: Screws

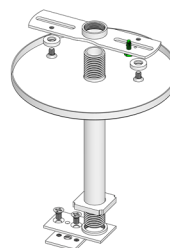

- C-515 TC MAG Canopy Kit for 3/8" IP Stem for Track system  
 1-#277B 5" Flat Canopy w/ .660" CH  
 1-#38 Crossbar Zinc W/GS  
 1-#22 3/8" IP Lock Nuts  
 2-Magnets  
 2-#270 8/32" x 1/4" L Screw  
 1-TC Base: Track Base  
 1-TC3/8: 3/8" IP Threaded Top Plate  
 2-#217: Ground Screws

Stems must be ordered separately and are not included in kits