

Pendant Systems

The Lighting Suspension Specialists www.PendantSystems.com P-215-638-8552 F-215-638-8554

Hardware

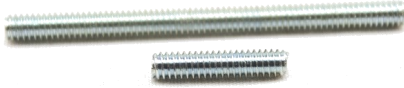

#214 8/32" x 2 1/4" L Male Stud Zinc Plated
#226 8/32" x 3/4" Male Stud Steel Zinc Plated



#273
 Half Dog Point Screw
 8/32" x .3235" L



MP Screws
 6/32" x 3/4" long zinc plated flat countersunk head machine screw. Available with Matte white, black or zinc finished heads



#109 Hanger Bolt
 2" L Hanger Bolt Zinc Plated
 Threaded 1" of 1/4"-20 Machine x 1" Lag



1/4"-20 Studs
#59-1 1/4"-20 Stud x 1" Long Steel
#59-2 1/4"-20 Stud x 2" Long Steel



#183
 8/32" x 1/4" Philip Head Ext Sems Steel Zinc Screw



1/4"-20 Bolts Zinc Plated
#69-1/4-20 x 3/4" Bolt
#69A-1/4-20 x 3/8" Bolt
#69B-1/4-20 x 3" Bolt



#150- 1/4"-20 Bolt
 Philips Countersunk 1/4"-20 Screw 3/4" Long for #158 Crossbar

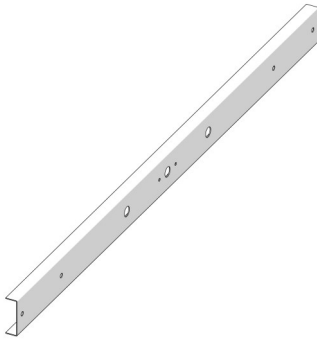

EXT Bracket
 Fits ALP, SLP, and Beghelli Vapor-Tite Bodies. 37.000" L x .750" H x 2.375" W



#Magnet
 #6 & #8 Magnet
 1/2" O.D. x 1/8" Thick Magnet w/ 8/32" & 6/32" Countersunk Holes



#211 8/32 Painted Screw
 8/32" x 1" Slotted Flat Head Machine Screw
 White Painted Head



#235 Self Tap Screw
 #8 X 1/2" White Screw



271
 6/32" x 1/4" Philips Flat Head Machine Screw Zinc Plated Used on Magnets

270
 8/32" x 1/4" Philips Flat Head Machine Screw Zinc Plated Used on Magnets

8/32" Machine Screws	
Catalog #	Description
217	8/32" x 5/16" Philips Flat Machine Screw
219	8/32" x 1/2" Philips Head Machine Screw
194	8/32" x 3/4" Philips Head Machine Screw
191	8/32" x 1/4" Slotted Round Head Machine Screw
190	8/32" x 1" Philips Head Machine Screw