

Pendant Systems

The Lighting Suspension Specialists www.PendantSystems.com P-215-638-8552 F-215-638-8554

MONO POINT STEM SERIES: MAGNET EXIT SIGN SYSTEM

- **Single Point Mounting System** for feed and fixture support from a center location for Exit Signs
- **Available in Round and Square Canopies**
- **Stem lengths are fixed and available in 1/4"IPS and 3/8"IPS.** (Stems must be ordered separately).
- **The Exit Bracket is adaptable to most signs** because it has multiple tapped holes for different mounting patterns

Patent# US 9133981B2

MP-ST1/4 Exit RD MAG- 1/4" IP Mono Point Exit Stem Kit

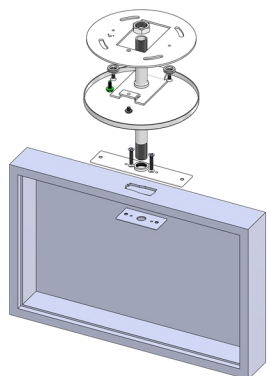

- 1- MP Crossbar Round: Mono Point Base Crossbar
- 1-#32: 8/32" x 5/16" Slot Ground Screw
- 1-#278B: 5" Square Canopy w/.530" CH
- 1-#64: 1/4"IP Hex Nut 1/4" Thick
- 1-#183: 8/32" x 1/4" Phillips Zinc Screw
- 1-MP PLATE 1/4IP: MP Plate w/ 1/4"IP Tapped CH
- 1-Exit Base: Bracket 6/32" Tapped & Slip Holes
- 1-Exit BRKT 1/4 IP: 1/4" IP Tapped CH & 6/32" Tapped
- 2-Exit BRKT Screw: 6/32" x 3/4" L Flat Head Phillips
- 2-Magnet: #6 & #8 Holes
- 2-#271: 6/32" x 1/4" L Flat Head Screw

**Sample Round Exit
Magnet kit**

MP-ST3/8 Exit MAG - 3/8"IP Mono Point Exit Stem Kit

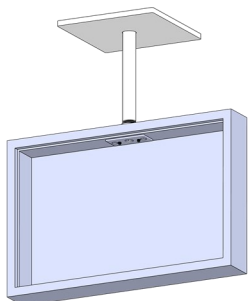

- 1- MP Crossbar: Mono Point Base Crossbar
- 1-#32: 8/32" x 5/16" Ground Screw
- 1-#277B SQ: 5" Square Canopy w/.660" CH
- 1-#22: 3/8"IP Square Nut
- 1-#183: 8/32" x 1/4" Phillips Zinc Screw
- 1-MP PLATE 3/8IP: MP Plate w/ 3/8"IP Tapped CH
- 1-Exit Base: Bracket 6/32" Tapped & Slip Holes
- 1-Exit BRKT 3/8 IP: 3/8" IP Tapped CH & 6/32" Tapped
- 2-Exit BRKT Screw: 6/32" x 3/4" L Flat Head Phillips
- 2-Magnet: #6 & #8 Holes
- 2-#271: 6/32" x 1/4" L Flat Head Screw

**Sample Square Exit
Magnet kit**

Pendant Systems

The Lighting Suspension Specialists www.PendantSystems.com P-215-638-8552 F-215-638-8554

MONO POINT STEM SERIES: MAGNET FIXED STEM FEED SYSTEM

- Single Point Mounting System for feed and fixture support from a center location
- Minimizes fixture movement
- Low profile with recessed 6/32" painted mounting screws for canopy
- Stem lengths are fixed and available in 1/4"IPS, 3/8"IPS & 1/2"IPS diameters.
(Stems must be ordered separately)

Patent# US 9133981B2

MP-ST1/4 MAG ID-1/4" IP MONO POINT STEM KIT

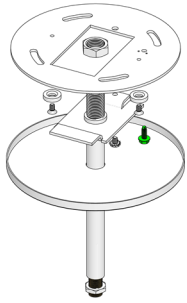

- 1- MP Crossbar: Mono Point Base Crossbar
- 1-#32: 8/32" x 5/16" Slot Ground Screw
- 1-#278B SQ: 5" Square Canopy w/.530" CH
- 1-#64: 1/4"IP Hex Nut 1/4" Thick
- 1-#183: 8/32" x 1/4" Phillips Zinc Screw
- 1-MP PLATE 1/4IP:MP Plate w/ 1/4"IP Tapped CH
- 1-#60-1: 1/8" IP Nipple 1" L
- 1-#133: 1/8" IP Nut 1/8" Thick
- 2-Magnet: #6 & #8 Holes
- 2-#271: 6/32" x 1/4" L Flat Head Screw

Sample of a Round Magnet Fixed Stem Kit for a Internal threaded stem

MP-ST3/8 MAG- 3/8"IP MONO POINT STEM KIT

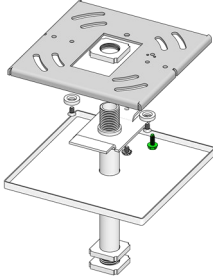

- 1- MP Crossbar: Mono Point Base Crossbar
- 1-#32: 8/32" x 5/16" Ground Screw
- 1-#277B SQ: 5" Square Canopy w/.660" CH
- 3-#22: 3/8"IP Square Nut
- 1-#183: 8/32" x 1/4" Phillips Zinc Screw
- 1-MP PLATE 3/8IP: MP Plate w/ 3/8"IP Tapped CH
- 2-Magnet: #6 & #8 Hole
- 2-#271: 6/32" x 1/4" Flat Head Screw

Sample of a Square Magnet Fixed Stem Kit

MP-ST1/2 RD MAG-1/2"IP MONO POINT STEM KIT

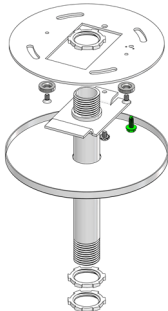

- 1- MP Crossbar Round: Mono Point Base Crossbar
- 1-#32: 8/32" x 5/16" Ground Screw
- 1-#279B: 5" Round Canopy w/.845" CH
- 3-#77: 1/2"IP Lock Nut
- 1-#183: 8/32" x 1/4" Phillips Zinc Screw
- 1-MP PLATE 1/2IP: MP Plate w/ 1/2"IP Tapped CH
- 2-Magnet: #6 & #8 Holes
- 2-#271: 6/32" x 1/4" L Flat Head Screw

Sample of a Round Magnet Fixed Stem Kit

Stems

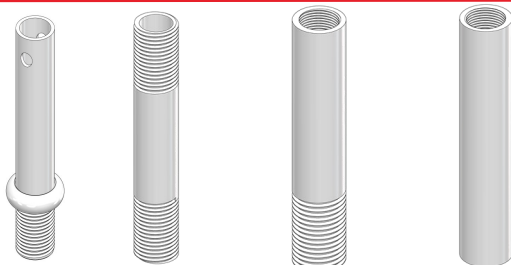

1/4" IPS, 3/8" IPS, and 1/2" IPS Stems are 16 gauge steel tubing and threaded 3/4" at each end.

Internal Diameter threading is now available on 1/4" IPS (1/8" IP thread) & 3/8" IPS (1/4" IP thread) steel tubing.

1/8"IPS Stem With Bead Nut and Pin Holes
20 Gauge x 36"Length x 9/16" Thread

Pendant Systems

The Lighting Suspension Specialists www.PendantSystems.com P-215-638-8552 F-215-638-8554

Magnet Mount Stem Kits

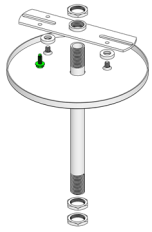

- C-415 MAG Canopy Kit for 1/4" IP Stem
 1-#278B Flat Canopy
 1-#39 1/4" IP Tapped Crossbar W/GS
 3-#25 1/4" IP Hex Nuts
 2-Magnets #6 & #8 Holes
 2-#270 8/32" Screws

Canopy set is also available in Square

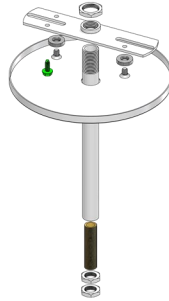

- C-415 MAG ID Canopy Kit for 1/4" IP Stem
 1-#278B Flat Canopy
 1-#39 1/4" IP Tapped Crossbar W/GS
 1-#25 1/4" IP Hex Nuts
 2-Magnets
 2-#270 8/32" Screws
 1-#60-1.5: 1/8" IP Nipple 1.5" L
 1-#133: 1/8" IP Nut 1/8" Thick

Canopy set is also available in Square

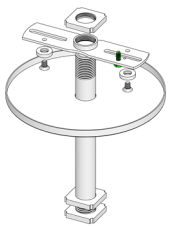

- C-515 MAG Canopy Kit for 3/8" IP Stem
 1-#277B Flat Canopy
 1-#38 Crossbar Zinc W/GS
 3-#22 3/8" IP Lock Nuts
 2-Magnets
 2-#270 8/32" Screw

Canopy set is also available in Square

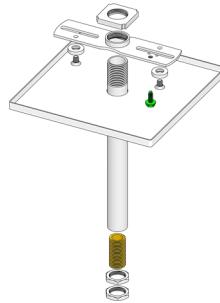

- C-515 MAG SQ ID Canopy Kit for 3/8" IP Stem
 1-#277B SQ Flat Canopy
 1-#38 Crossbar Zinc W/GS
 1-#22 3/8" IP Lock Nuts
 2-#25 1/4" IP Lock Nuts
 1-#49-1 1/4" IP Nipple 1" L
 2-Magnets
 2-#270 8/32" Screws

Canopy set is also available in Round

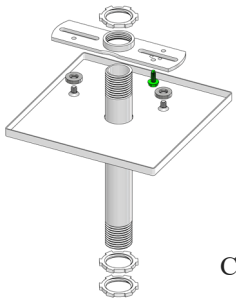

- C-615 Square MAG Canopy Kit for 1/2" IP Stem
 1-#146 Flat Canopy S.R.I. White
 1-#159 1/2" IP Tapped Crossbar W/GS
 2-#77 1/2" IP Lock Nuts
 2-Magnets
 2-#270 8/32" Screw

Canopy set is also available in Round

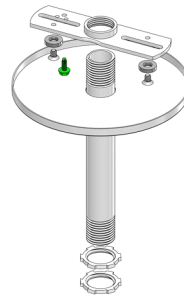

- C-615 MAG Canopy Kit for 1/2" IP Stem
 1-#88 Flat Canopy S.R.I. White
 1-#159 1/2" IP Tapped Crossbar W/GS
 2-#77 1/2" IP Lock Nuts
 2-Magnets
 2-#270 8/32" Screw

Exit Magnet Mount Stem Kits

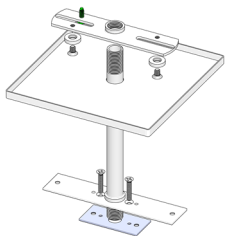

- C-415 Square Exit MAG Canopy Kit for 1/4" IP Stem
 1-#278B Flat Canopy
 1-#39 Crossbar Zinc W/GS
 2-#64 1/4" IP Lock Nuts
 2-Magnets
 2-#270 8/32" Screw
 1-Exit Base
 1-Exit Bracket 1/4" IP White
 2-Mono Point Screws

Canopy set is also available in Round

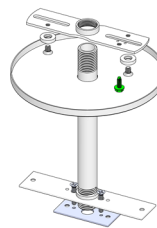

- C-515 Exit MAG Canopy Kit for 3/8" IP Stem
 1-#277B 5" Flat Canopy w/ .660" CH
 1-#38 Crossbar Zinc W/GS
 2-#22 3/8" IP Lock Nuts
 2-Magnet
 2-#270 8/32" x 1/4" screw
 1-Exit Base
 1-Exit Bracket 3/8" IP White
 2-Mono Point Screws

Canopy set is also available in Square

Magnet Track Clip Kits

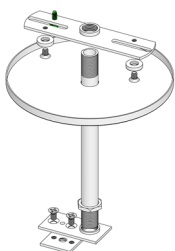

- C-415 TC MAG Canopy Kit for 1/4" IP Stem for Track system
 1-#278B 5" Flat Canopy w/ .530" CH
 1-#39 1/4" IP Tapped Crossbar W/GS
 1-#25 1/4" IP Hex Nuts
 2-Magnet
 2-#270 8/32" x 1/4" L Screw
 1-Track Base
 1- TC1/4: 1/4" IP Threaded Top Plate
 2-#217: Screws

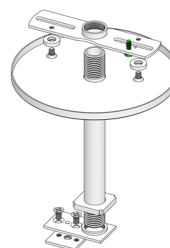

- C-515 TC MAG Canopy Kit for 3/8" IP Stem for Track system
 1-#277B 5" Flat Canopy w/ .660" CH
 1-#38 Crossbar Zinc W/GS
 1-#22 3/8" IP Lock Nuts
 2-Magnets
 2-#270 8/32" x 1/4" L Screw
 1-TC Base: Track Base
 1-TC3/8: 3/8" IP Threaded Top Plate
 2-#217: Ground Screws

Stems must be ordered separately and are not included in kits