

***Reference Bill of Materials on Page 4**

STEM LENGTH WILL VARY. ORDER SEPARATELY
MP SW 3/8 EX RD MAG USED WITH STEM 3/8"
IP
3/8" IPS .625"-.635" O.D. 18 T.P.I.
Add Suffix WHT for White or BK for Black

***38° SWIVEL**

This Document
Contains Proprietary
Data that is property
of Pendant Systems
which reserves all
rights to it.
Unauthorized use
without authorization
is prohibited.

Pendant Systems

1670 Winchester Rd.
Bensalem, PA 19020
P-215-638-8552
F-215-638-8554
www.PendantSystems.com

EXIT SIGN
(BY OTHERS)

| | | | |
|--|---------------|-----------------------------------|--------------|
| UNLESS OTHERWISE SPECIFIED DIMENSIONS ARE IN BOTH INCHES & MILLIMETERS UNLESS OTHERWISE NOTED TOLERANCES: LINEAR: XX= .02" XXX= $\pm .010"$ ANGULAR: ± 1 Degree | | TITLE: MP SW 3-8 EX RD MAG | |
| DO NOT SCALE DRAWING | MATERIAL: | Part # | REVISION |
| DEBUR AND BREAK SHARP EDGES | | | |
| DRAWN DATE: 5/9/17 | Drawn By: MWR | SCALE: NTS | SHEET 1 OF 4 |

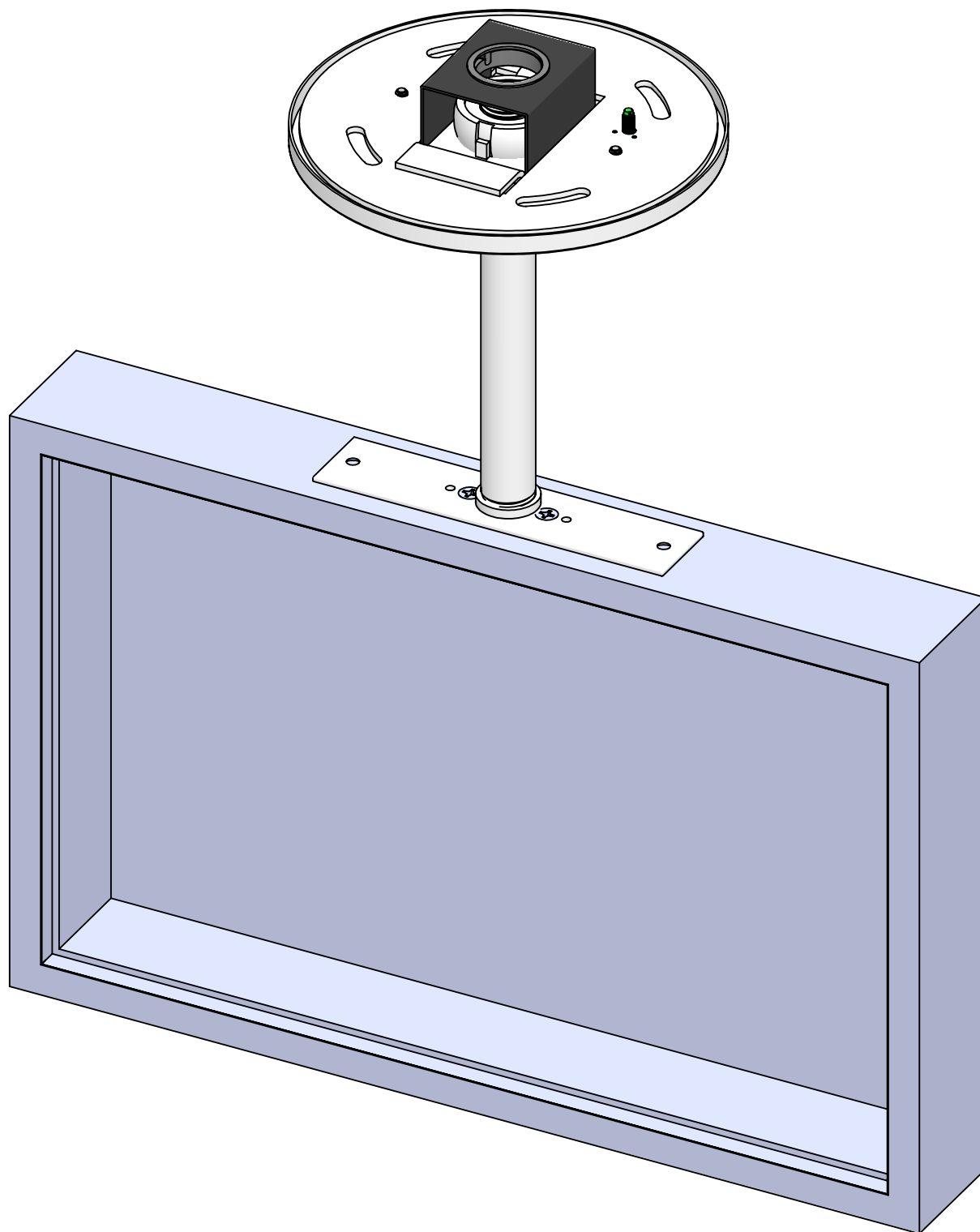

This Document
Contains Proprietary
Data that is property
of Pendant Systems
which reserves all
rights to it.
Unauthorized use
without authorization
is prohibited.

Pendant Systems

1670 Winchester Rd.
Bensalem, PA 19020
P-215-638-8552
F-215-638-8554
www.PendantSystems.com

UNLESS OTHERWISE SPECIFIED DIMENSIONS ARE IN BOTH INCHES &
MILLIMETERS UNLESS OTHERWISE NOTED TOLERANCES:

LINEAR: XX= .02" XXX= $\pm .010"$ ANGULAR: ± 1 Degree

FINISH:

TITLE:

MP SW 3-8 EX RD MAG Assembled

DO NOT SCALE DRAWING

MATERIAL:

Part #

DEBUR AND BREAK SHARP EDGES

REVISION

DRAWN DATE: 5/9/17

Drawn By: MWR

SCALE: NTS

SHEET 2 OF 4

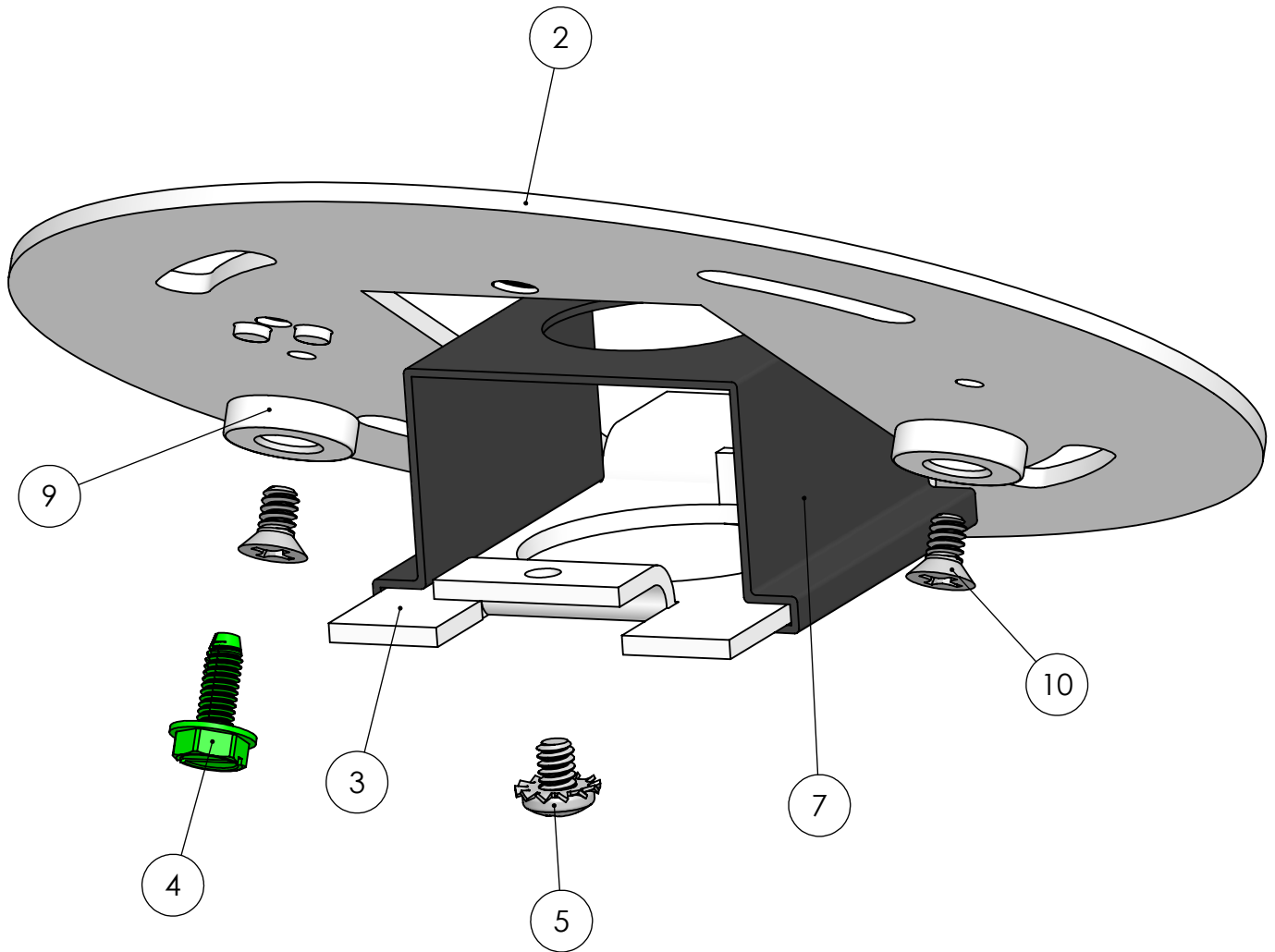

This Document
Contains Proprietary
Data that is property
of Pendant Systems
which reserves all
rights to it.
Unauthorized use
without authorization
is prohibited.

Pendant Systems

1670 Winchester Rd.
Bensalem, PA 19020
P-215-638-8552
F-215-638-8554
www.PendantSystems.com

UNLESS OTHERWISE SPECIFIED DIMENSIONS ARE IN BOTH INCHES &
MILLIMETERS UNLESS OTHERWISE NOTED TOLERANCES:
LINEAR: XX= .02" XXX= $\pm .010"$ ANGULAR: ± 1 Degree

FINISH:

TITLE: MP SW RD MAG Instruction

DO NOT SCALE DRAWING
DEBUR AND BREAK SHARP EDGES

MATERIAL:

Part #

DRAWN DATE: 5/9/17

Drawn By: MWR

SCALE: NTS SHEET 3 OF 4 REVISION

| ITEM NO. | PART NUMBER | DESCRIPTION | QTY. |
|----------|---------------------|---|------|
| 1 | 276 | 5" Round w/ 1.18" CH | 1 |
| 2 | MP Crossbar Round | 4.75" Round Crossbar .080" Material Thickness Zinc Plated Steel | 1 |
| 3 | MP Plate HB | Monopoint Plate for Half Ball for MP Crossbar 2.82" L x 1.650" W x .075" Material Thickness Half Ball Opening for #35, #34 and #147 Tapped 8/32" Hole Zinc Plated Steel | 1 |
| 4 | #32 | 8/32 Green Ground Screw | 1 |
| 5 | 183 | 8/32" x 1/4" Philip Head Ext Sems Steel Zinc Screw | 1 |
| 6 | #34 | 3/8" IP Tap Half Ball | 1 |
| 7 | MP Swivel Clip | Mono Point Swivel Retaining Clip for MP-Plate HB Spring Steel | 1 |
| 8 | #237 | .875" Hole Bushing .945" W x .750" I.D. x .250" H .063" Max Panel Thickness | 1 |
| 9 | Magnet | #6 & #8 Magnet | 2 |
| 10 | 271 | 6/32" x 1/4" L Flat Head Philips Machine Screw | 2 |
| 11 | Exit Bracket 3-8 IP | Exit Bracket with 3/8" IP tapped center hole & 6/32" tapped holes. 4.5" x .875" (Available in white, nickel and black) | 1 |
| 12 | Exit Base | Exit Bracket Base 6/32" Slip & Tapped Holes. 2" x .875" Zinc Plated | 1 |
| 13 | Exit Bracket Screws | 6/32" Screws | 2 |

This Document Contains Proprietary Data that is property of Pendant Systems which reserves all rights to it. Unauthorized use without authorization is prohibited.

Pendant Systems

1670 Winchester Rd.
Bensalem, PA 19020
P-215-638-8552
F-215-638-8554
www.PendantSystems.com

UNLESS OTHERWISE SPECIFIED DIMENSIONS ARE IN BOTH INCHES & MILLIMETERS UNLESS OTHERWISE NOTED TOLERANCES:
LINEAR: XX= .02" XXX= $\pm .010"$ ANGULAR: ± 1 Degree

FINISH:

TITLE:

Bill of Materials

DO NOT SCALE DRAWING

MATERIAL:

Part #

DEBUR AND BREAK SHARP EDGES

REVISION

DRAWN DATE: 5/9/17

Drawn By: MWR

SCALE: NTS

SHEET 4 OF 4