

**\*3/8" IPS (Iron Pipe Standard)  
Actual Outer Diameter is  
.625"-.635" (5/8")  
\*1/4" IPS Inner Diameter is  
.500"-.510" (1/2")**

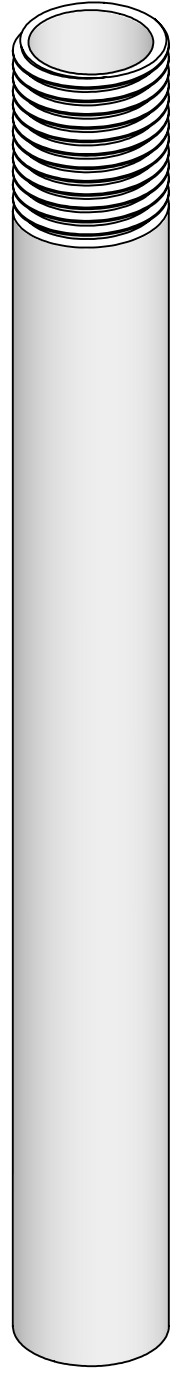
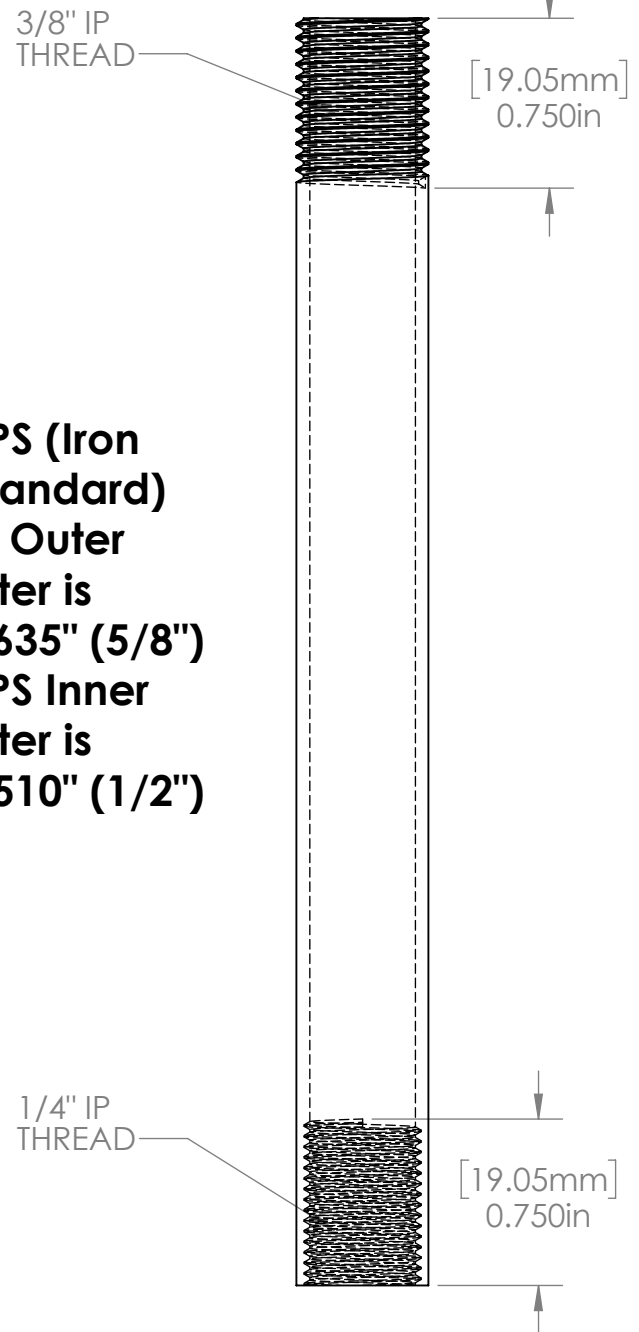

3/8"IPS Stems (Iron Pipe Standard)  
.625" – .635" O.D. 3/4" x 3/4" Thread  
18 Threads per Inch, 16 Gauge  
Add Suffix WHT for White, BK for Black, or  
Raw for Unfinished. Add PH for 1/8" Pin Hole  
for Adjustable Field Cut System

This Document  
Contains Proprietary  
Data that is property  
of Pendant Systems  
which reserves all  
rights to it.  
Unauthorized use  
without authorization  
is prohibited.

**Pendant Systems**  
1670 Winchester Rd.  
Bensalem, PA 19020  
P-215-638-8552  
F-215-638-8554  
[www.PendantSystems.com](http://www.PendantSystems.com)

UNLESS OTHERWISE SPECIFIED DIMENSIONS ARE IN BOTH INCHES & MILLIMETERS UNLESS OTHERWISE NOTED TOLERANCES: LINEAR: XX= .02" XXX= ±.010" ANGULAR: ± 1 Degree		FINISH:		TITLE: [XX] Stem 3-8IP O.D.-I.D.	
DO NOT SCALE DRAWING		MATERIAL:		Part #	
DEBUR AND BREAK SHARP EDGES				REVISION	
DRAWN DATE: 1/27/17		Drawn By: MWR		SCALE: NTS	
				SHEET 1 OF 1	