

**\*Reference Bill of Materials on Page 4**

STEM LENGTH WILL VARY. ORDER SEPARATELY  
 MP SW 3/8 EX RD MAG USED WITH STEM 3/8"  
 IP  
 3/8" IPS .625"-.635" O.D. 18 T.P.I.  
 Add Suffix WHT for White or BK for Black

\*45° SWIVEL

This Document  
 Contains Proprietary  
 Data that is property  
 of Pendant Systems  
 which reserves all  
 rights to it.  
 Unauthorized use  
 without authorization  
 is prohibited.

**Pendant Systems**

1670 Winchester Rd.  
 Bensalem, PA 19020  
 P-215-638-8552  
 F-215-638-8554  
 www.PendantSystems.com

UNLESS OTHERWISE SPECIFIED DIMENSIONS ARE IN BOTH INCHES &  
 MILLIMETERS UNLESS OTHERWISE NOTED TOLERANCES:

LINEAR: XX= .02" XXX=  $\pm$ .010" ANGULAR:  $\pm$  1 Degree

FINISH:

TITLE:

MP SW 3-8 EX RD MAG

DO NOT SCALE DRAWING

MATERIAL:

Part #

DEBUR AND BREAK SHARP EDGES

REVISION

DRAWN DATE: 5/9/17

Drawn By: MWR

SCALE: NTS

SHEET 1 OF 4

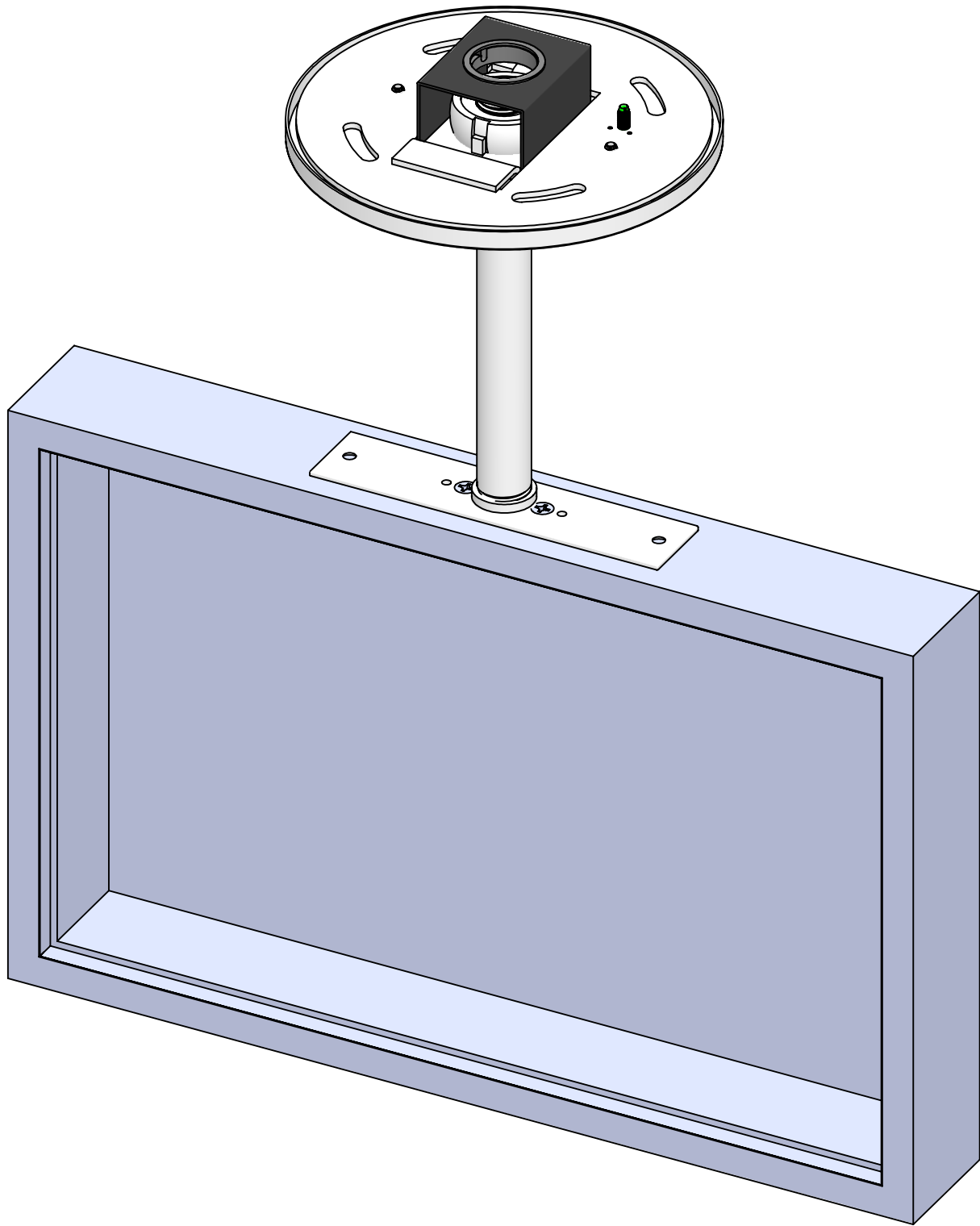

This Document  
Contains Proprietary  
Data that is property  
of Pendant Systems  
which reserves all  
rights to it.  
Unauthorized use  
without authorization  
is prohibited.

# Pendant Systems

1670 Winchester Rd.  
Bensalem, PA 19020  
P-215-638-8552  
F-215-638-8554  
[www.PendantSystems.com](http://www.PendantSystems.com)

UNLESS OTHERWISE SPECIFIED DIMENSIONS ARE IN BOTH INCHES & MILLIMETERS UNLESS OTHERWISE NOTED TOLERANCES:

LINEAR: XX= .02" XXX=  $\pm .010"$  ANGULAR:  $\pm 1$  Degree

FINISH:

TITLE:

MP SW 3-8 EX RD MAG Assembled

DO NOT SCALE DRAWING

MATERIAL:

Part #

DEBUR AND BREAK SHARP EDGES

REVISION

DRAWN DATE: 5/9/17

Drawn By: MWR

SCALE: NTS

SHEET 2 OF 4

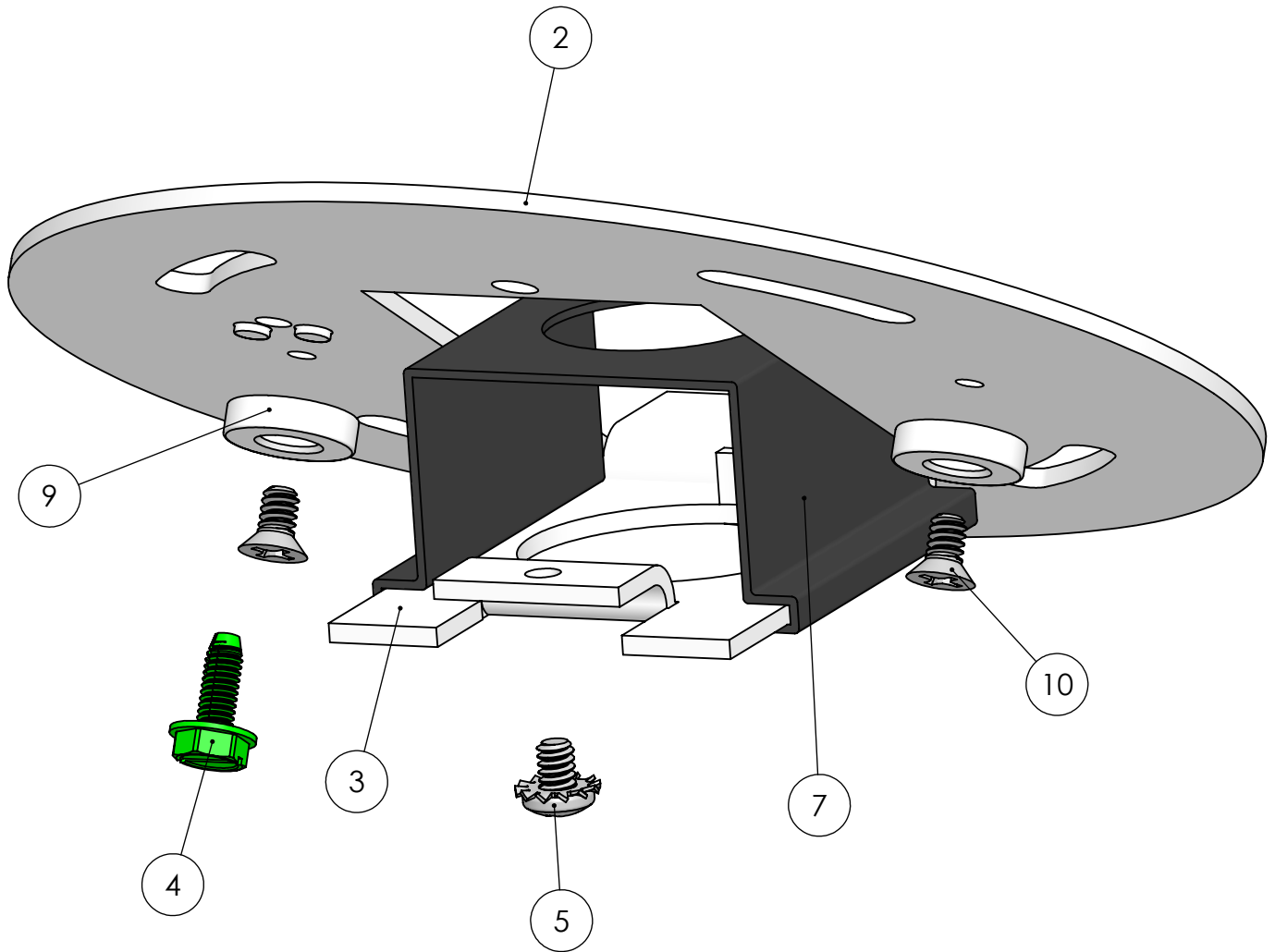

This Document  
Contains Proprietary  
Data that is property  
of Pendant Systems  
which reserves all  
rights to it.  
Unauthorized use  
without authorization  
is prohibited.

# Pendant Systems

1670 Winchester Rd.  
Bensalem, PA 19020  
P-215-638-8552  
F-215-638-8554  
[www.PendantSystems.com](http://www.PendantSystems.com)

UNLESS OTHERWISE SPECIFIED DIMENSIONS ARE IN BOTH INCHES & MILLIMETERS UNLESS OTHERWISE NOTED TOLERANCES:

LINEAR: XX= .02" XXX=  $\pm .010"$  ANGULAR:  $\pm 1$  Degree

FINISH:

TITLE:

MP SW RD MAG Instruction

DO NOT SCALE DRAWING

MATERIAL:

Part #

DEBUR AND BREAK SHARP EDGES

REVISION

DRAWN DATE: 5/9/17

Drawn By: MWR

SCALE: NTS

SHEET 3 OF 4

| ITEM NO. | PART NUMBER         | DESCRIPTION  | QTY. |
|----------|---------------------|--|------|
| 1        | 276                 | 5" Round w/ 1.18" CH   | 1    |
| 2        | MP Crossbar Round   | 4.75" Round Crossbar .080" Material Thickness Zinc Plated Steel  | 1    |
| 3        | MP Plate HB         | Monopoint Plate for Half Ball for MP Crossbar<br>2.82" L x 1.650" W x .075" Material Thickness<br>Half Ball Opening for #35,#34 and #147<br>Tapped 8/32" Hole<br>Zinc Plated Steel | 1    |
| 4        | #32                 | 8/32 Green Ground Screw  | 1    |
| 5        | 183                 | 8/32" x 1/4" Philip Head Ext Sems Steel Zinc Screw   | 1    |
| 6        | #34                 | 3/8" IP Tap Half Ball  | 1    |
| 7        | MP Swivel Clip      | Mono Point Swivel Retaining Clip for MP-Plate HB Spring Steel  | 1    |
| 8        | #237                | .875" Hole Bushing .945" W x .750" I.D. x .250" H .063" Max Panel Thickness  | 1    |
| 9        | Magnet              | #6 & #8 Magnet   | 2    |
| 10       | 271                 | 6/32" x 1/4" L Flat Head Philips Machine Screw   | 2    |
| 11       | Exit Bracket 3-8 IP | Exit Bracket with 3/8" IP tapped center hole & 6/32" tapped holes. 4.5" x .875" (Available in white, nickel and black)   | 1    |
| 12       | Exit Base           | Exit Bracket Base 6/32" Slip & Tapped Holes. 2" x .875" Zinc Plated  | 1    |
| 13       | Exit Bracket Screws | 6/32" Screws   | 2    |

This Document Contains Proprietary Data that is property of Pendant Systems which reserves all rights to it. Unauthorized use without authorization is prohibited.

## Pendant Systems

1670 Winchester Rd.  
Bensalem, PA 19020  
P-215-638-8552  
F-215-638-8554  
[www.PendantSystems.com](http://www.PendantSystems.com)

UNLESS OTHERWISE SPECIFIED DIMENSIONS ARE IN BOTH INCHES & MILLIMETERS UNLESS OTHERWISE NOTED TOLERANCES:

LINEAR: XX= .02" XXX=  $\pm .010"$  ANGULAR:  $\pm 1$  Degree

FINISH:

TITLE:

Bill of Materials

DO NOT SCALE DRAWING

MATERIAL:

Part #

DEBUR AND BREAK SHARP EDGES

REVISION

DRAWN DATE: 5/9/17

Drawn By: MWR

SCALE: NTS

SHEET 4 OF 4