

ITEM NO.	PART NUMBER	DESCRIPTION	QTY.
1	#35	1/4" IP Tap Half Ball	1
2	MP Plate HB	Monopoint Plate for Half Ball for MP Crossbar 2.82" L x 1.650" W x .075" Material Thickness Half Ball Opening for #35, #34 and #147 Tapped 8/32" Hole Zinc Plated Steel	1
3	MP Swivel Clip	Mono Point Swivel Retaining Clip for MP-Plate HB Spring Steel	1
4	#64	1/4" IP x 3/4 O.D. x 1/4" Thick Zinc Plated	2
5	#183	8/32" x 1/4" Philip Head Ext Sems Steel Zinc Screw	1
6	#237	.875" Hole Bushing .945" W x .750" I.D. x .250" H .063" Max Panel Thickness	1
7	276	5" Round w/ 1.18" CH	1
8	MP Crossbar Round	4.75" Round Crossbar .080" Material Thickness Zinc Plated Steel	1
9	Magnet	#6 & #8 Magnet	2
10	271	6/32" x 1/4" L Flat Head Philips Machine Screw	2
11	#32	8/32 Green Ground Screw	1

**STEM LENGTH WILL VARY. ORDER SEPARATELY
MP SW1/4 RD MAG USED WITH STEM 1/4" IP
1/4" IPS .500"-.510" O.D. 18 T.P.I.**

*50° SWIVEL

This Document Contains Proprietary Data that is property of Pendant Systems which reserves all rights to it. Unauthorized use without authorization is prohibited.

Pendant Systems
1670 Winchester Rd.
Bensalem, PA 19020
P-215-638-8552
F-215-638-8554
www.PendantSystems.com

UNLESS OTHERWISE SPECIFIED DIMENSIONS ARE IN BOTH INCHES & MILLIMETERS UNLESS OTHERWISE NOTED TOLERANCES: LINEAR: XX= .02" XXX= $\pm .010"$ ANGULAR: ± 1 Degree	FINISH:	TITLE: MP SW 1-4 RD MAG
DO NOT SCALE DRAWING DEBUR AND BREAK SHARP EDGES	MATERIAL:	Part #
DRAWN DATE: 11/7/16	Drawn By: MWR	SCALE: NTS SHEET 1 OF 2 REVISION

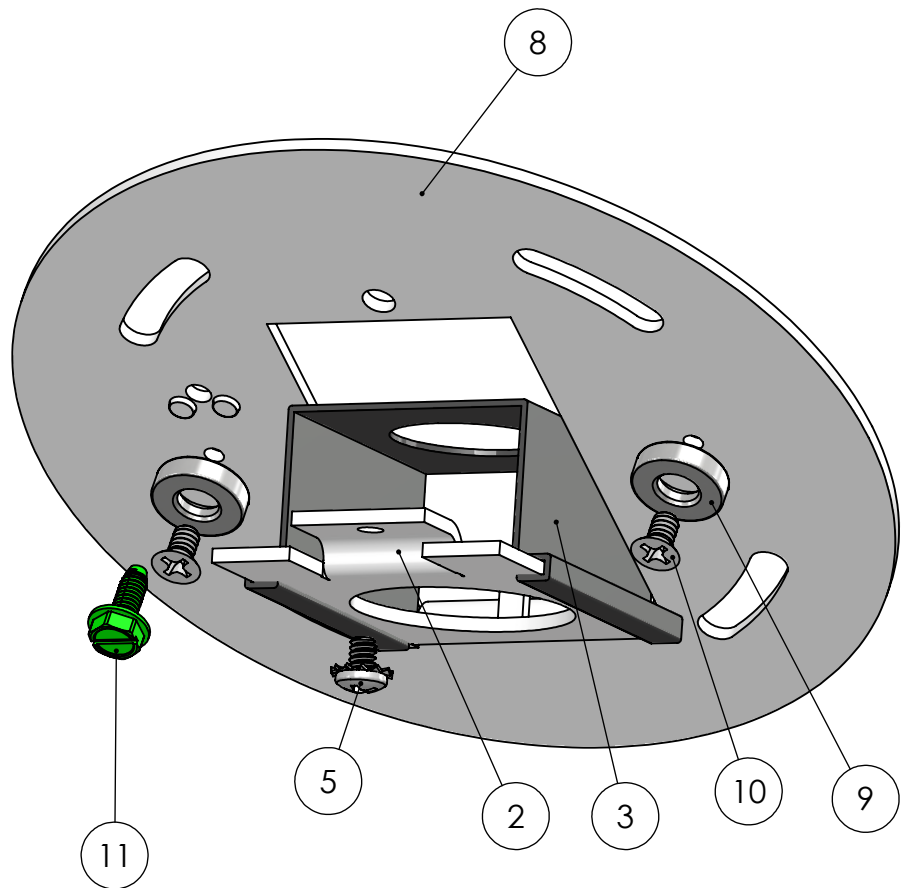
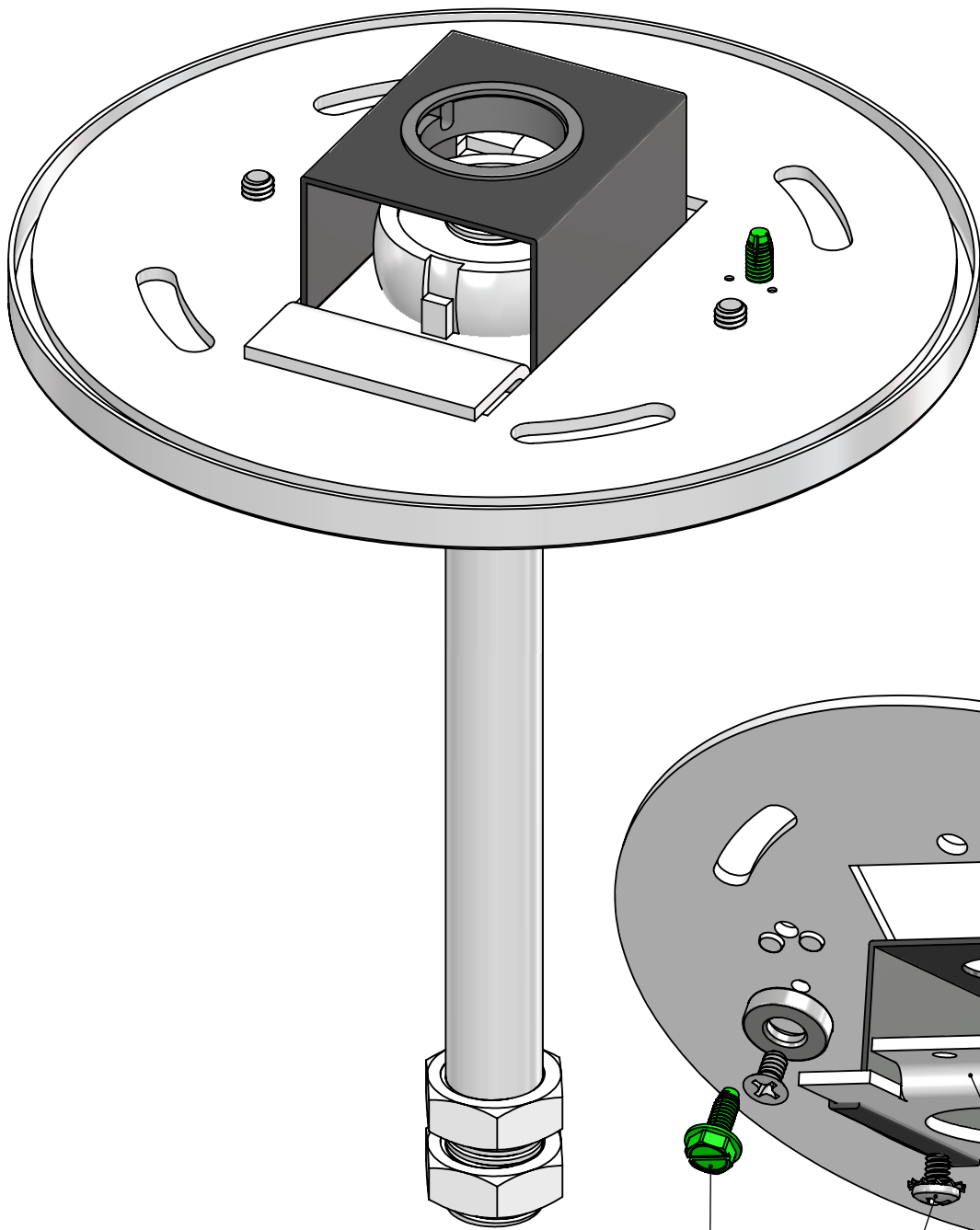

This Document
Contains Proprietary
Data that is property
of Pendant Systems
which reserves all
rights to it.
Unauthorized use
without authorization
is prohibited.

Pendant Systems
1670 Winchester Rd.
Bensalem, PA 19020
P-215-638-8552
F-215-638-8554
www.PendantSystems.com

UNLESS OTHERWISE SPECIFIED DIMENSIONS ARE IN INCHES & MILLIMETERS UNLESS OTHERWISE NOTED TOLERANCES:
LINEAR: XX= .02' XXX= \pm .010" ANGULAR: \pm 1 Degree

FINISH:
MATERIAL:

TITLE:
MP SW 1-4 RD MAG Assembled
Part #

DO NOT SCALE DRAWING
DEBUR AND BREAK SHARP EDGES

Drawn By: MWR

SCALE:NTS

SHEET 2 OF 2

REVISION

DRAWN DATE: 11/7/16