

ITEM NO.	PART NUMBER	DESCRIPTION	QTY.
1	#242B SQ RM	Monopoint Canopy with 6/32" Mounting Holes .875" Center Hole	1
2	MP Crossbar	Crossbar 14 Gauge Zinc Plated Steel 4.8" L x 4.8" W x .075" Material Thickness	1
3	#32	8/32 Green Ground Screw	1
4	#183	8/32" x 1/4" Philip Head Ext Sems Steel Zinc Screw	1
5	MP Plate 1-2 IP	1/2" IP Monopoint Plate for MP Crossbar 2.82" L x 1.650" W x .075" Material Thickness Tapped 8/32" Hole Zinc Plated Steel	1
6	#77	1/2" IP Locknut Zinc Plated 1.14"O.D. x .125" H	3
7	MP Screws	6/32" x 3/4" Long Zinc Plated Flat Countersunk Head Machine Screw. Available with White, Black or Zinc Finished Heads	2

STEM LENGTH WILL VARY. ORDER SEPARATELY
MP-ST1/2 USED WITH STEM 1/2" IP
1/2" IPS .800"-.810" O.D. 14 T.P.I.

This Document Contains Proprietary Data that is property of Pendant Systems which reserves all rights to it. Unauthorized use without authorization is prohibited.

Pendant Systems
 1670 Winchester Rd.
 Bensalem, PA 19020
 P-215-638-8552
 F-215-638-8554
 www.PendantSystems.com

UNLESS OTHERWISE SPECIFIED DIMENSIONS ARE IN BOTH INCHES & MILLIMETERS UNLESS OTHERWISE NOTED TOLERANCES:
 LINEAR: XX= .02" XXX= +.010" ANGULAR: +.1 Degree

FINISH:

TITLE: MP-ST1-2

DO NOT SCALE DRAWING
 DEBUR AND BREAK SHARP EDGES

MATERIAL:

Part #

DRAWN DATE: 5/18/16

Drawn By: MWR

SCALE: NTS

SHEET 1 OF 2

REVISION

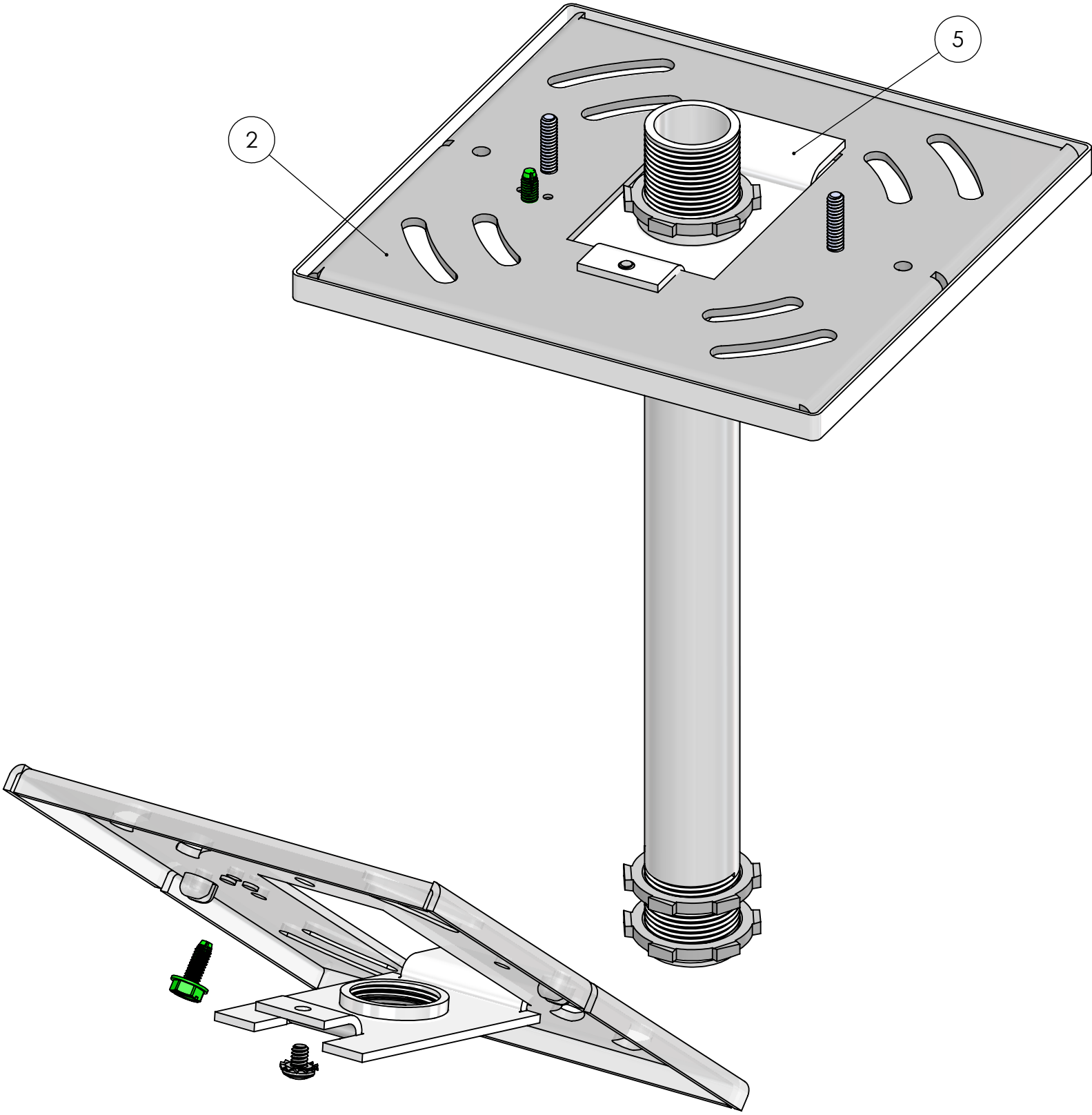

This Document
Contains Proprietary
Data that is property
of Pendant Systems
which reserves all
rights to it.
Unauthorized use
without authorization
is prohibited.

Pendant Systems
1670 Winchester Rd.
Bensalem, PA 19020
P-215-638-8552
F-215-638-8554
www.PendantSystems.com

UNLESS OTHERWISE SPECIFIED DIMENSIONS ARE IN BOTH INCHES & MILLIMETERS UNLESS OTHERWISE NOTED TOLERANCES:
LINEAR: XX= .02" XXX= $\pm .010$ " ANGULAR: ± 1 Degree

FINISH:
MATERIAL:

TITLE: MP-ST1-2 Assembled

DO NOT SCALE DRAWING
DEBUR AND BREAK SHARP EDGES

Part #

SCALE: NTS SHEET 2 OF 2 REVISION

DRAWN DATE: 5/18/16

Drawn By: MWR

SCALE: NTS SHEET 2 OF 2 REVISION